

2 - lags

Dato 12.12.2013	Tegn. M.B.Gilje	Godkjert T.Gilje	Revisjon 10.02.2015	Format 1 : 1	Ark nr.
Beskrivelse Gilje innadslående			Sammenstilling/Del bunn topp		Tegn. nr. 22IT68LLB562L--

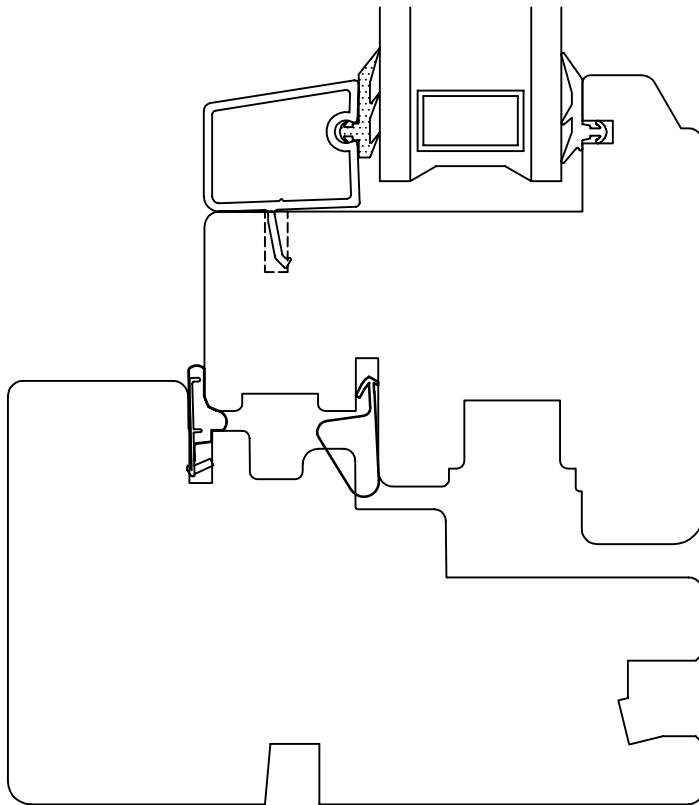

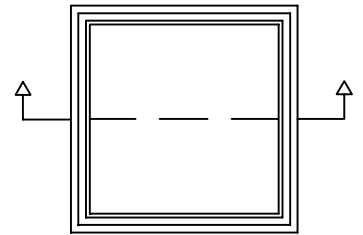
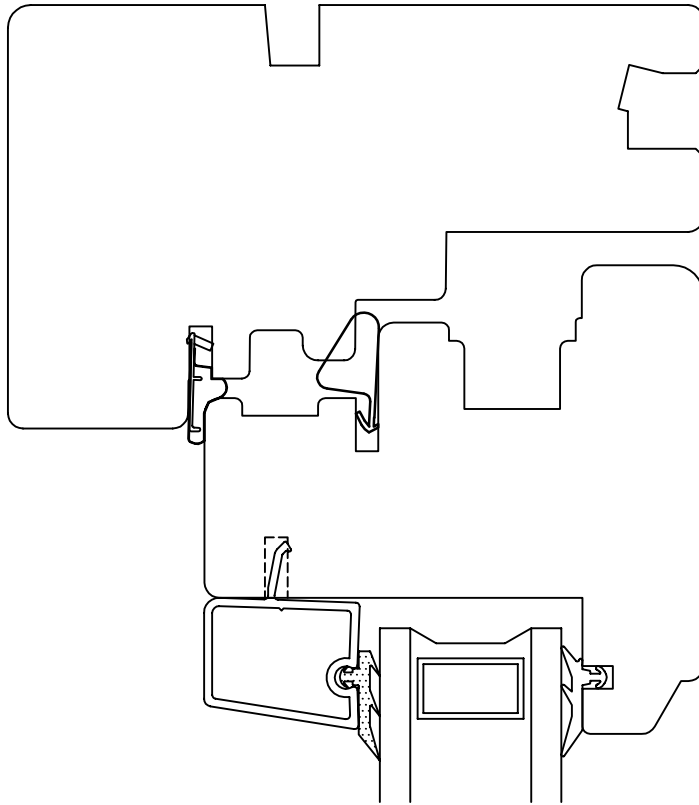

2 - lags

Dato 12.12.2013	Tegn. M.B.Gilje	Godkjert T.Gilje	Revisjon 10.02.2015	Format 1 : 1	Ark nr.
Beskrivelse Gilje innadslående			Sammenstilling/Del sider		Tegn. nr. 22IS56LLS562L--



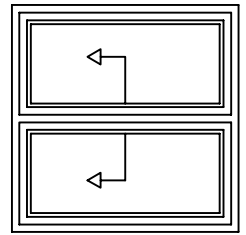
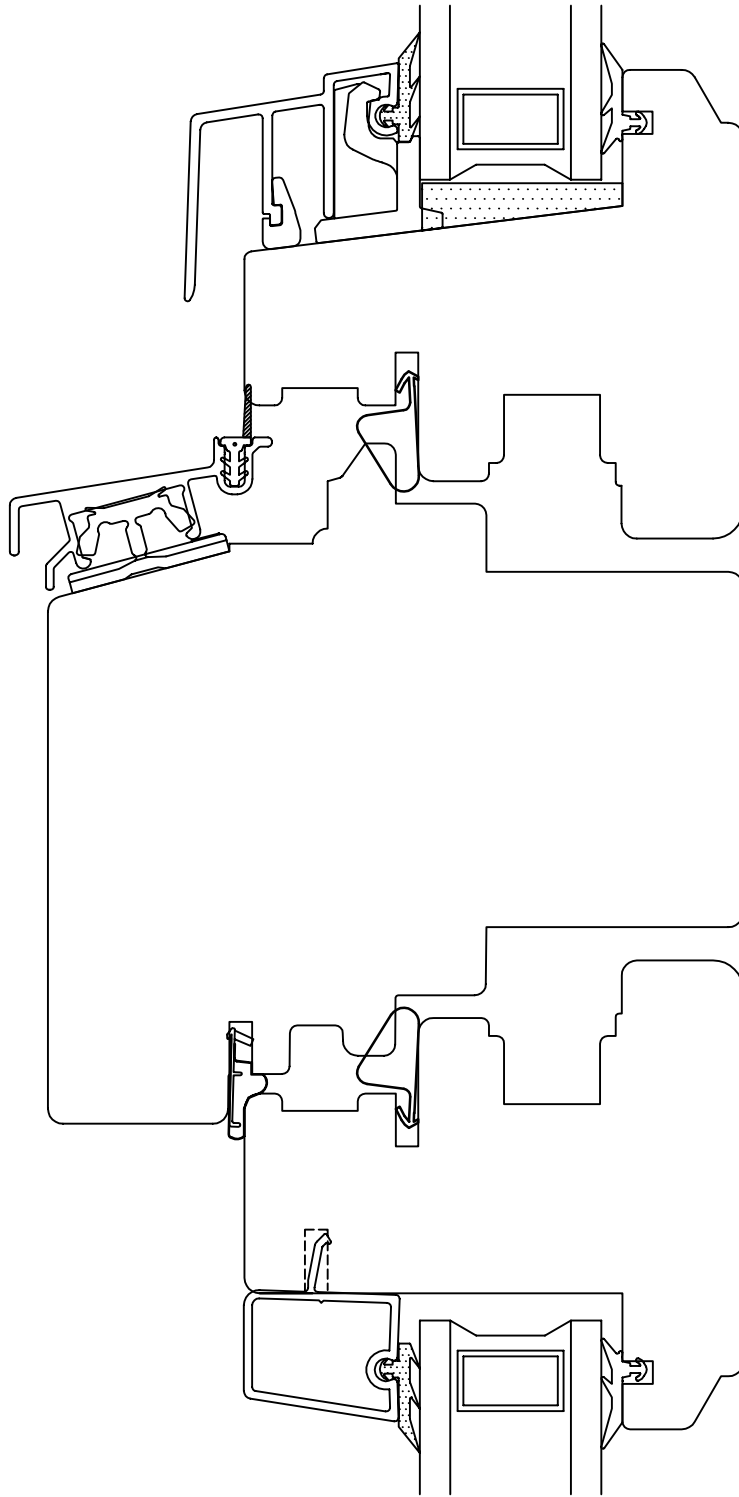

2 - lags

Dato 12.12.2013	Tegn. M.B.Gilje	Godkjert T.Gilje	Revisjon 10.02.2015	Format 1 : 1	Ark nr.
Beskrivelse Gilje innadslående			Sammenstilling/Del 90 mm losholt	Tegn. nr. 22IL90LL--2L--	



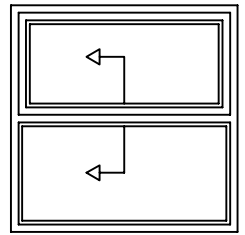
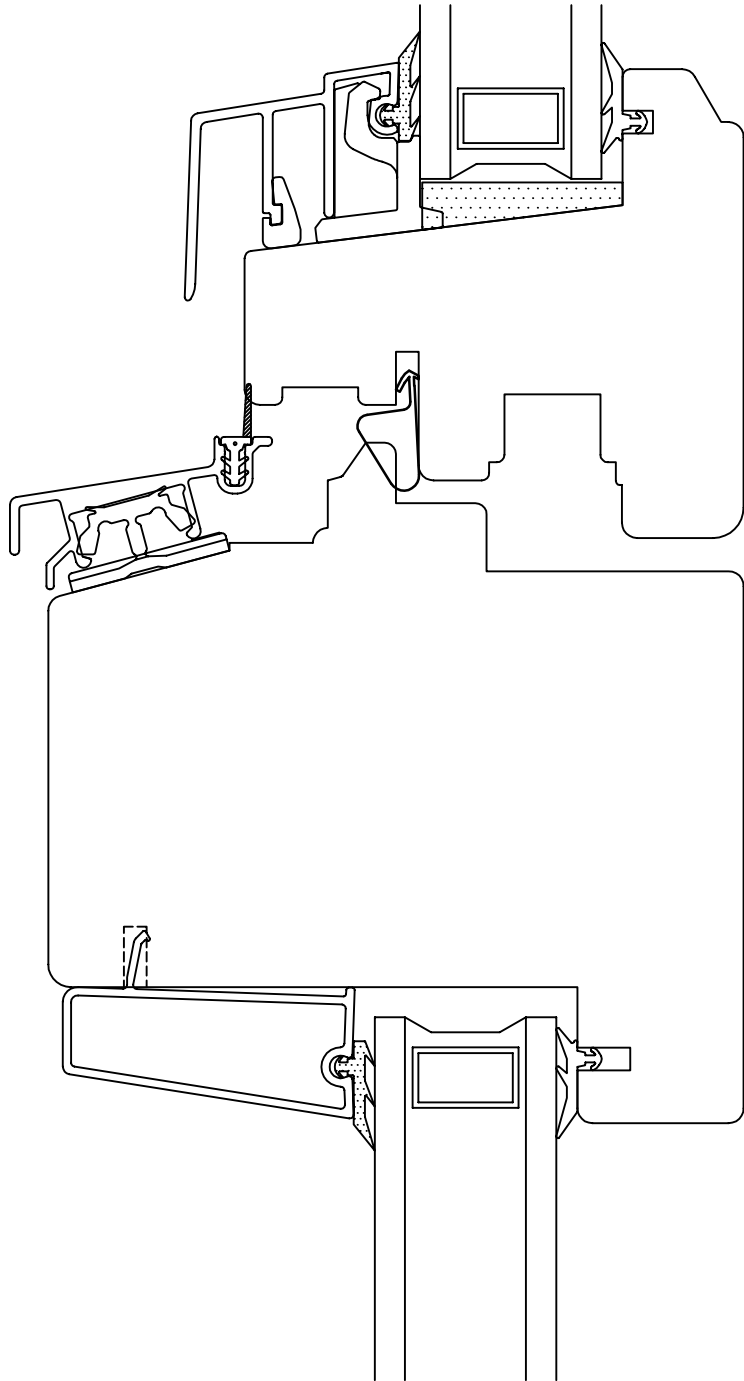

2 - lags

Dato 12.12.2013	Tegn. M.B.Gilje	Godkjert T.Gilje	Revisjon 10.02.2015	Format 1 : 1	Ark nr.
Beskrivelse Gilje innadslående			Sammenstilling/Del fast 90 mm losholt u.	Tegn. nr. 22IL90LF--2L--	



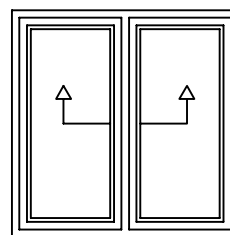
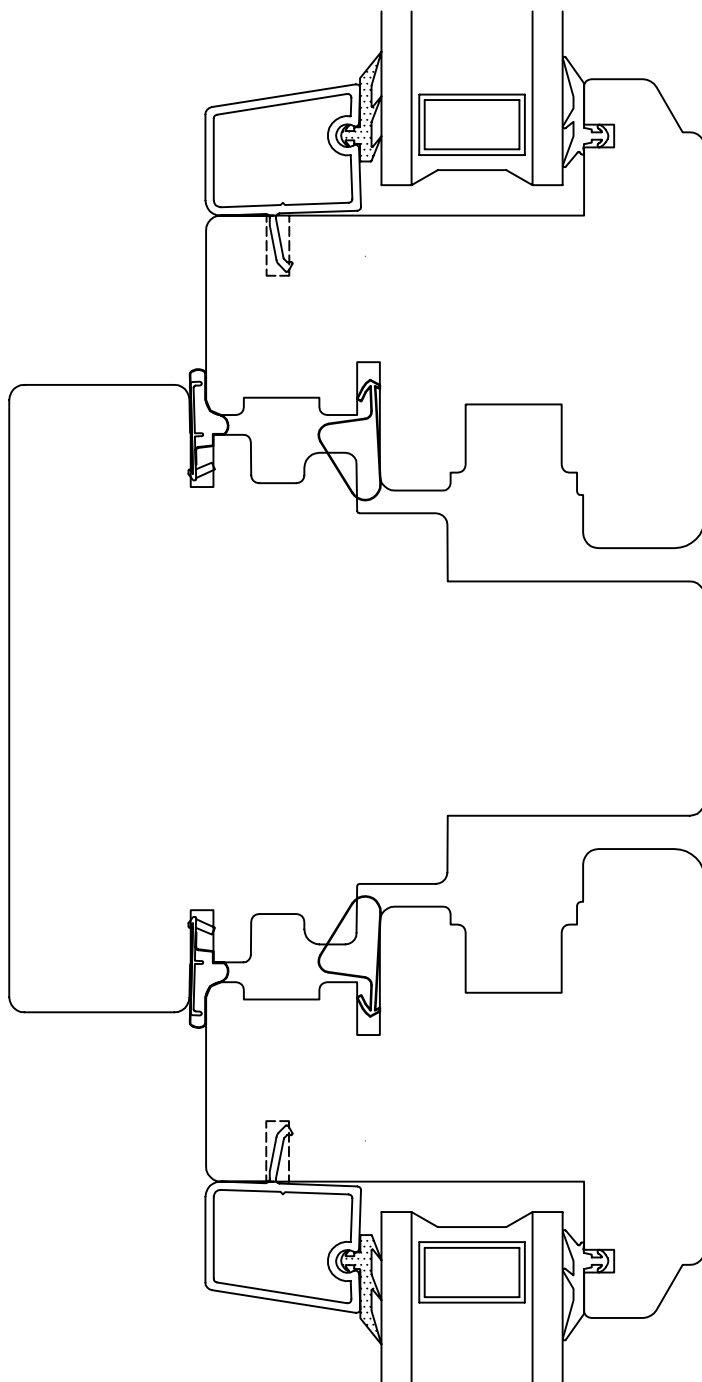

2 - lags

Dato 12.12.2013	Tegn. M.B.Gilje	Godkjert T.Gilje	Revisjon 10.02.2015	Format 1 : 1	Ark nr.	
Beskrivelse Gilje innadslående			Sammenstilling/Del 83 mm post		Tegn. nr. 22IP83LL--2L--	

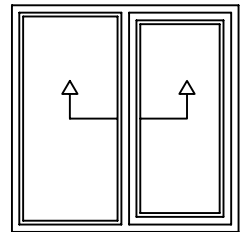
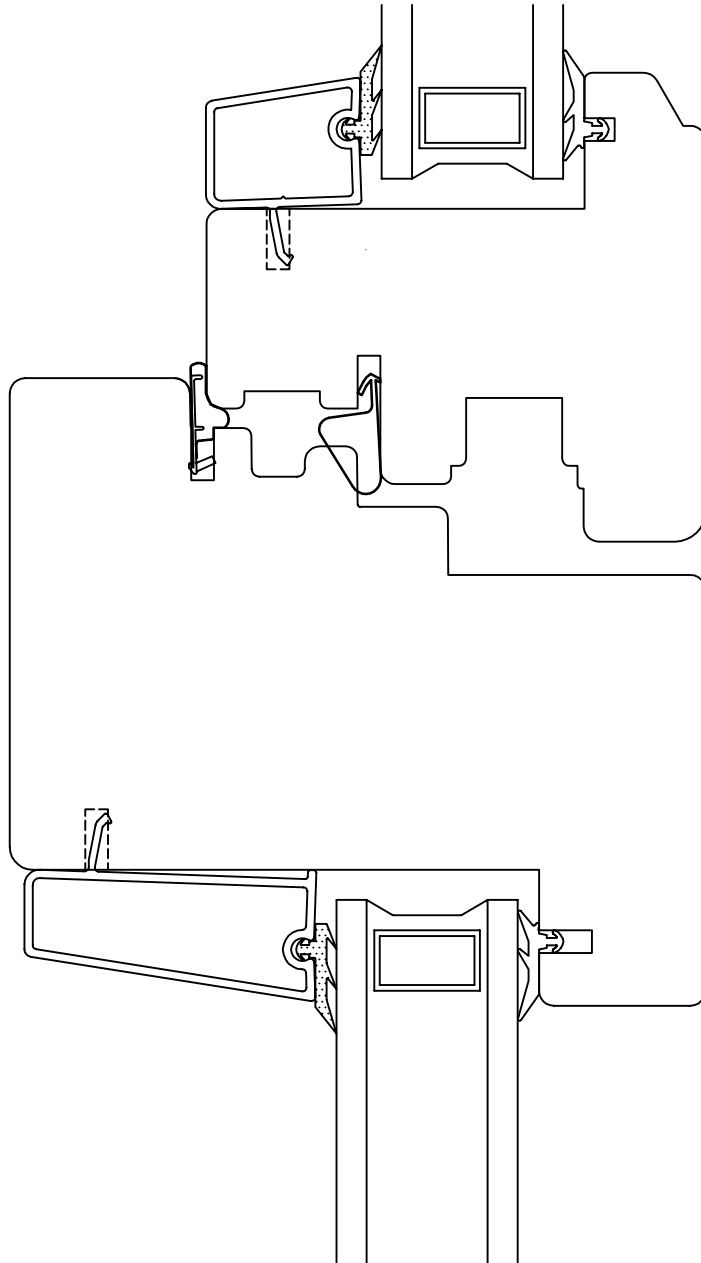

2 - lags

Dato 12.12.2013	Tegn. M.B.Gilje	Godkjert T.Gilje	Revisjon 10.02.2015	Format 1 : 1	Ark nr.
Beskrivelse Gilje innadslående			Sammenstilling/Del 83 post, fast del en s.	Tegn. nr. 22IP83LF--2L--	

